

ARC Euro Adapter -cv

Quick
guide

The ARC Euro Adapter allows you to use Kemppi's ARC Quality system for monitoring any welding machine equipped with a Euro connector. For more information about Kemppi's welding quality management solutions, please visit www.kemppi.com.

1. Three wire liners are included in the package. Select one of them according to the filler wire size you are using, and install the liner into the adapter.
2. Connect the ARC Euro Adapter to the Euro connector at the wire feeder. Push the connector and turn clockwise until it's firmly seated.
3. Connect the welding gun to the ARC Euro Adapter. Push the connector and turn clockwise until it's firmly seated.
4. Attach the ARC Control Cable to the adapter and turn clockwise until it is firmly seated.
5. Connect the ARC Control Cable to the Adapter Power Source.
6. Connect the ARC Quality Smart Reader to the ARC Control Cable.
7. Connect the voltage sensing cable between the branch connector and the Adapter Power Source. It is used for measuring welding voltage.
8. Plug in the Adapter Power Source to a 230 – 400 V wall socket or the mains connector inside the power source.
9. Test that the system works.

i All installations inside Kemppi welding machines may be carried out only by an authorized electrician.

The maximum allowed welding current is 500 A.

The 'CV' stands for the qualities being measured (Current and Voltage).

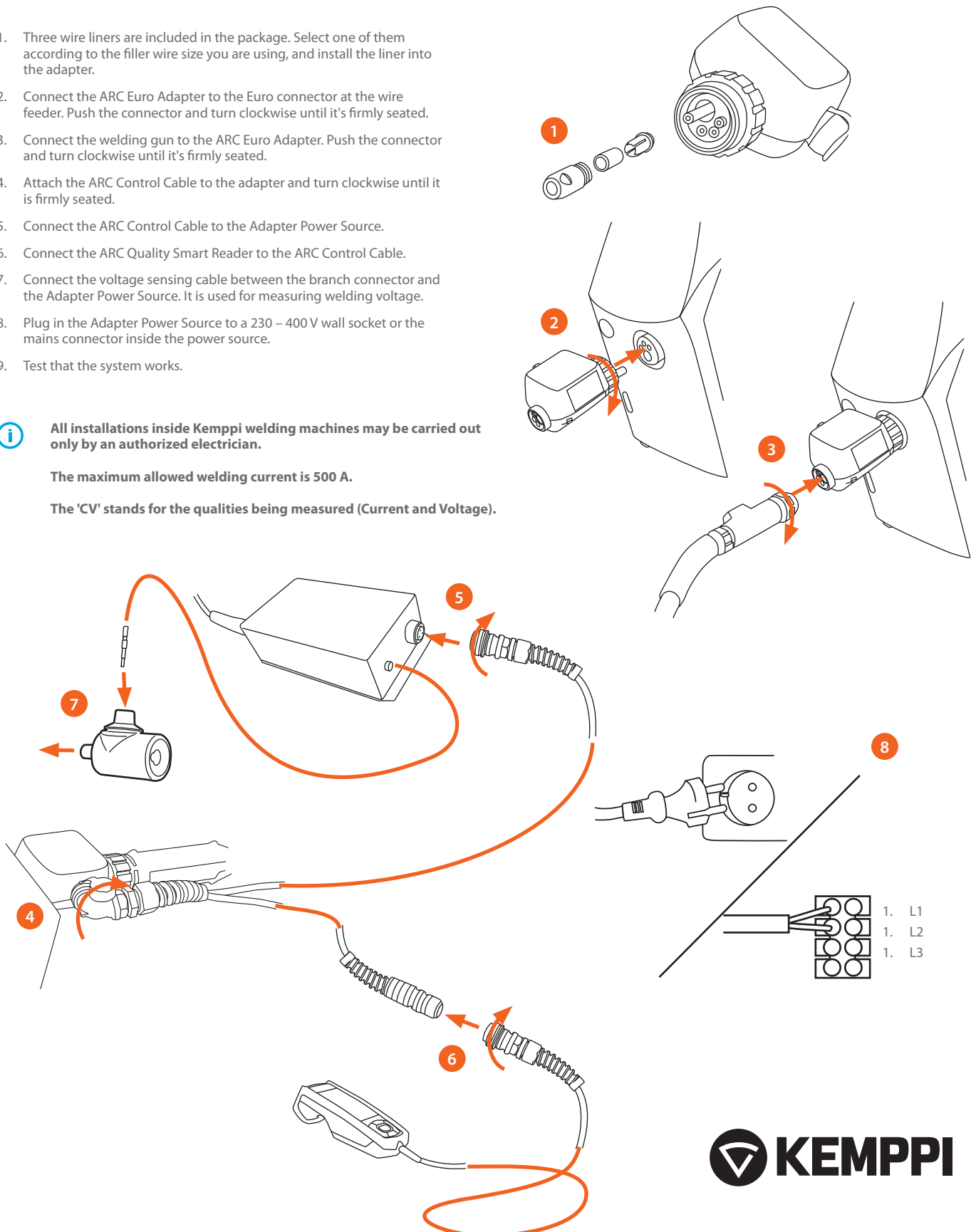

Wire path maintenance

i You must know the correct tension torques before you start repairing the connections.

i Only an authorised electrician may repair the machine.

To service or change the wire guide, remove the 3 adaptor bushes.

SP007205 wire guide set	
1 pc	wire guide (0.8 – 1.0)
1 pc	wire guide (1.0 – 1.4)
1 pc	wire guide (1.2 – 1.6)
1 pc	adaptor bush
1 pc	adaptor bush
1 pc	adaptor bush

Three wire guide sizes are available in packages of 5 pcs.

Wire guides					
wire ø mm	guide markings	length	colour	pcs	code
0.8 – 1.0	KEMPPi 5.9/1.5	120	orange	5	W007111
1.0 – 1.4	KEMPPi 5.9/2.0	120	orange	5	W007112
1.4 – 1.6	KEMPPi 5.9/2.5	120	orange	5	W007113

Clean every three months:

Clean the inner parts of the machine from dust and dirt e.g. with a soft brush and avacuum cleaner.

Do not use compressed air because there is the danger that the dirt is packed even more tightly in the gaps of the cooling profiles.

Do not use a pressure washer.

Wire liner must be changed and wire conductor cleaned also to ensure wire speed measurement.

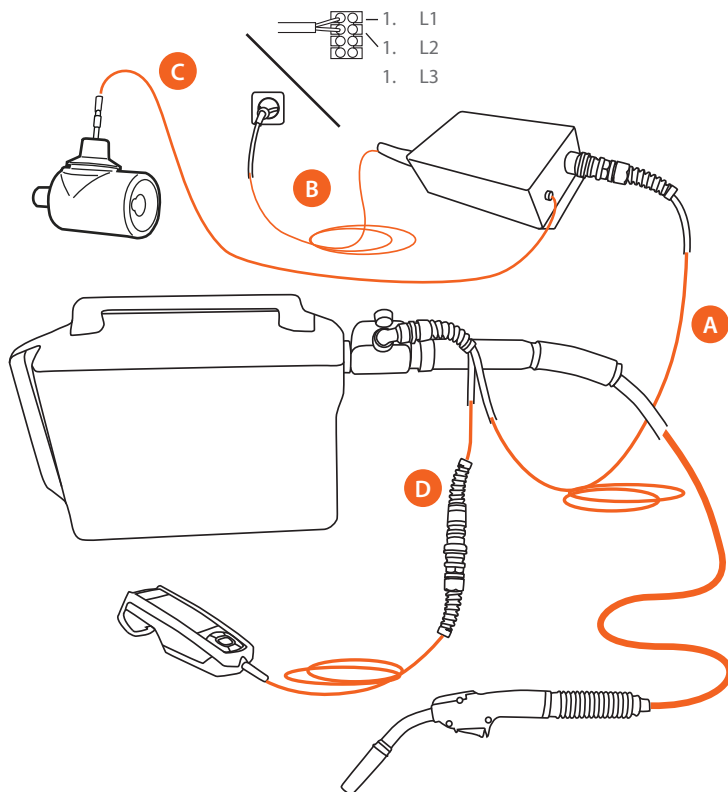

A.	Interconnection cable 12 V	
	5 m	6260700
	25 m	6260701
	50 m	6260702
B.	Input cable	
	1.5 m (4x1.5)	SP007928
C.	Measuring cable	
	1.5 m	SP007898
D.	DIX angle connector	
		SP003482

1918560
1607