

ARC Euro Adapter -CV

Quick guide

The ARC Euro Adapter allows you to use Kemppi's WeldEye welding management software for monitoring any welding machine equipped with a Euro connector. For more information about Kemppi's welding quality management solutions, please visit www.weldeye.com.

1. Three wire liners are included in the package. Select one of them according to the filler wire size you are using, and install the liner into the adapter.
2. Connect the ARC Euro Adapter to the Euro connector on the wire feeder. Push the connector and turn clockwise until it's firmly seated.
3. Connect the welding gun to the ARC Euro Adapter. Push the connector and turn clockwise until it's firmly seated.
4. Attach the ARC Control Cable to the adapter and turn clockwise until it is firmly seated.
5. Connect the ARC Control Cable to the Adapter Power Source.
6. Connect the Smart Reader or the Digital Connectivity Module (DCM) to the ARC Control Cable.
7. Connect the branch connector to the welding equipment and connect the voltage sensing cable between the branch connector and the Adapter Power Source.
8. Install the plug and plug in the Adapter Power Source to a 220 – 415 V wall socket. Alternatively the Adapter Power Source can be connected to the mains connector inside the power source.
9. Test that the system works.



The plug installation and all installations inside Kemppi welding machines may be carried out only by an authorized electrician.

The maximum allowed welding current is 500 A.

The 'CV' stands for the qualities being measured (Current and Voltage).

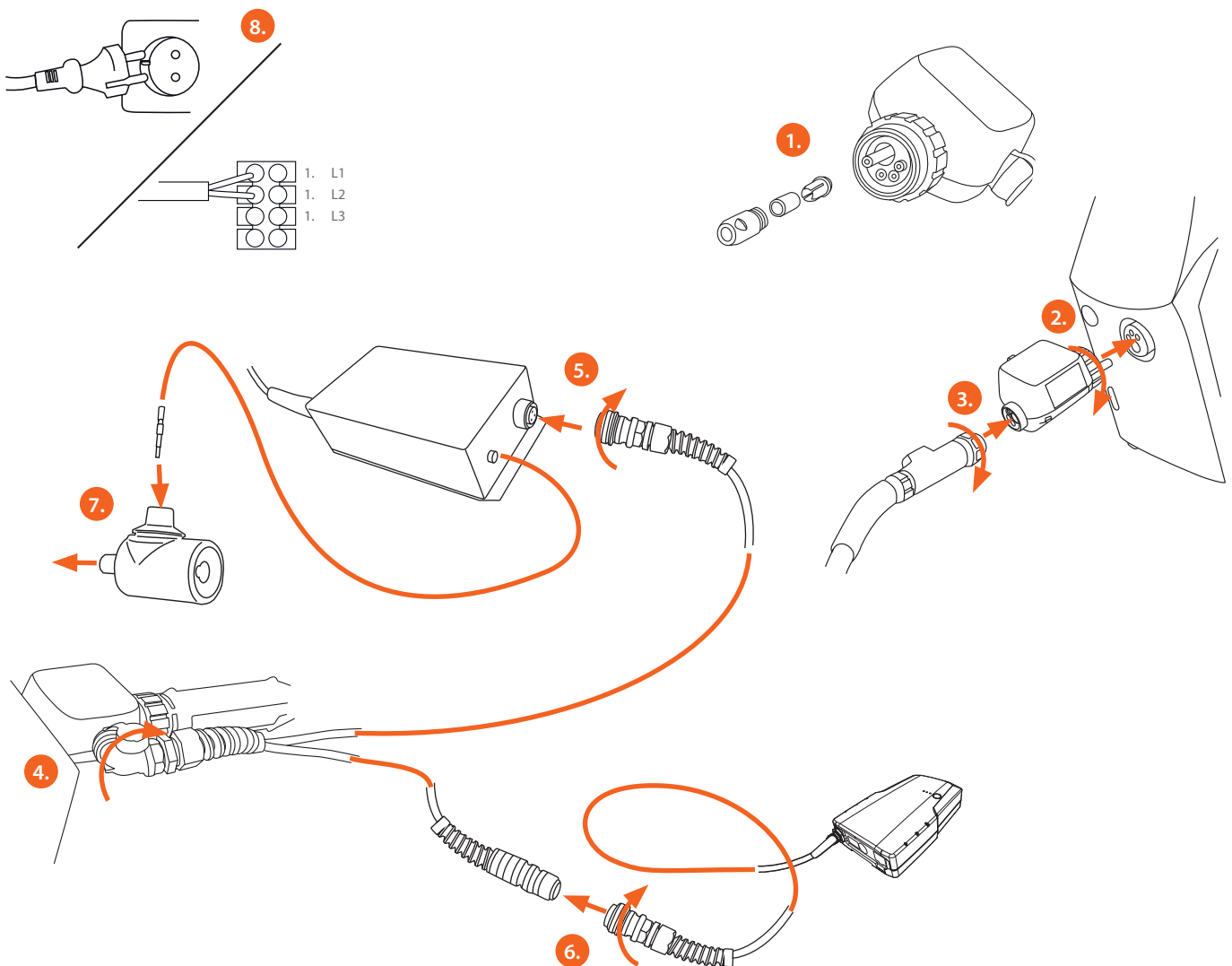

(Turn the page for a full setup overview.)

Wire path maintenance

i You must know the correct tension torques before you start repairing the connections.

i Only an authorised electrician may repair the machine.

To service or change the wire guide, remove the 3 adaptor bushes.

SP011107 wire guide set	
1 pc	wire guide (0.8 – 1.0)
1 pc	wire guide (1.0 – 1.4)
1 pc	wire guide (1.2 – 1.6)
1 pc	adaptor bush
1 pc	adaptor bush
1 pc	adaptor bush

Three wire guide sizes are available in packages of 5 pcs.

Wire guides					
wire ø mm	guide markings	length	colour	pcs	code
0.8 – 1.0	KEMPPi 5.9/1.5	120	orange	5	W007111
1.0 – 1.4	KEMPPi 5.9/2.0	120	orange	5	W007112
1.4 – 1.6	KEMPPi 5.9/2.5	120	orange	5	W007113

Clean every three months:

Clean the parts from dust and dirt e.g. with a soft brush and avacuum cleaner.

Do not use compressed air because there is the danger that the dirt is packed even more tightly in the gaps of the cooling profiles.

Do not use a pressure washer.

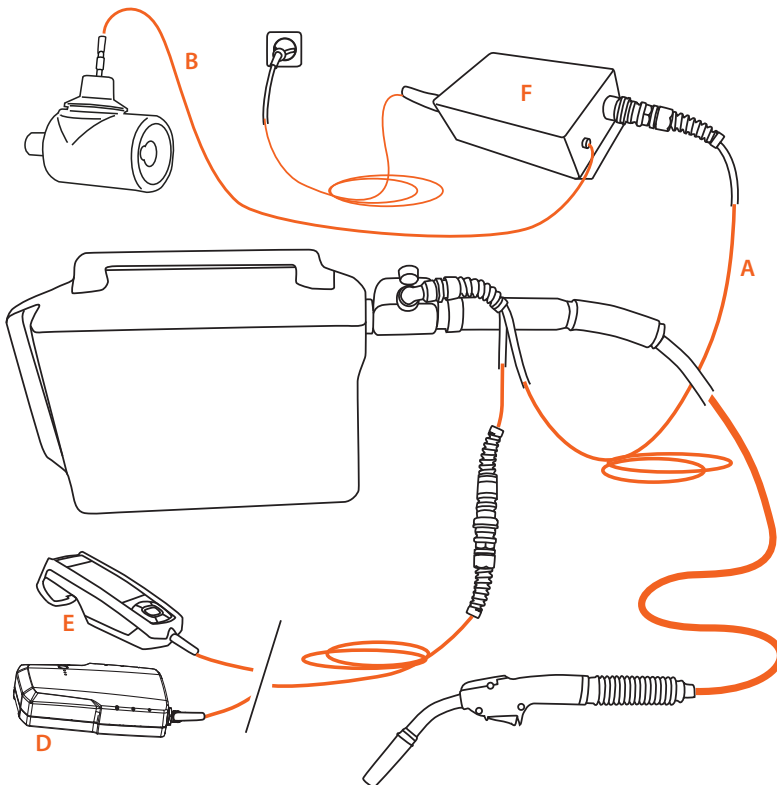

A.	Arc control cable	
	2 m	6185940
	25 m	6185941
B.	Voltage sensing cable	
	1.5 m	SP007898
C.	Universal Sensor MMA KIT	SP008897
D.	Digital Connectivity Module (DCM)	6265051
E.	Smart Reader	6265043
F.	Adapter power source	6185950

1918560
1931