

EN Quick guide
DA Kvik guide
DE Kurzanleitung
ES Guía rápida
FI Pikaohje
FR Guide de démarrage rapide
IT Guida rapida
NL Verkorte handleiding
NO Kom i gang
PL Skrócona instrukcja obsługi
PT Guia de consulta rápida
RU Краткое руководство
SV Snabbguide
ZH 快速指南



**Quick
guide**

ARC |
Mobile Control



go.kemppi.com/googleplay/arcmc

ARC Mobile Control

1



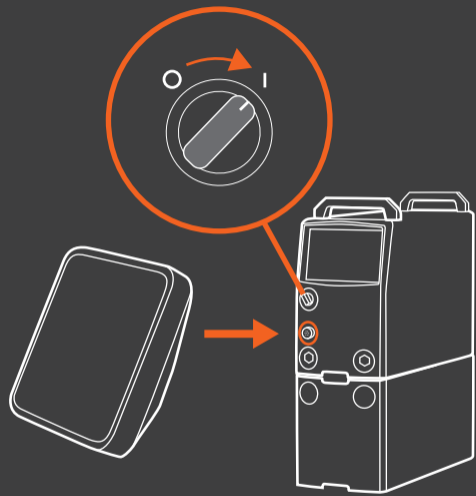

2

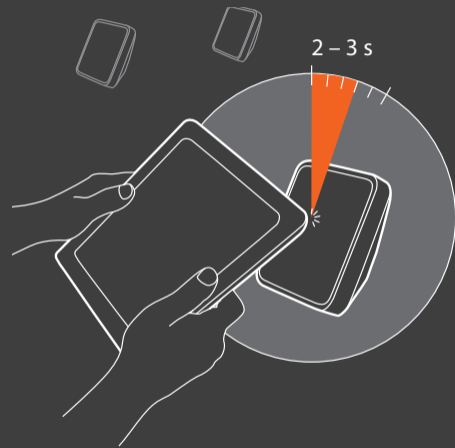

3a

✓ NFC

3b

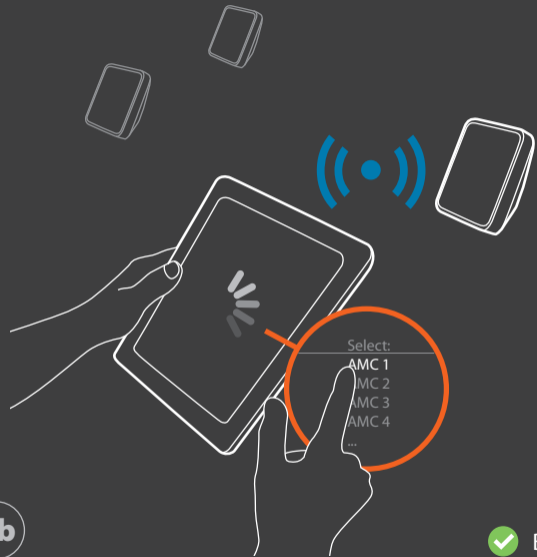

✔ Bluetooth

4

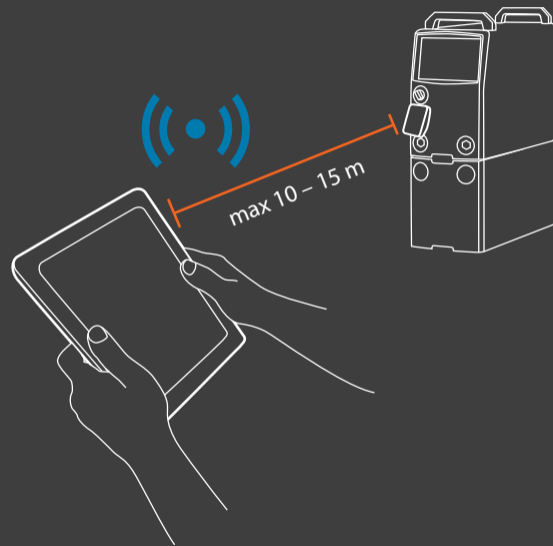

CE

Kemppi hereby declares that this ARC Mobile Control adapter is in compliance with the essential requirements and other relevant provisions of Directive 1999/5/EC. Declaration of conformity is available at <http://go.kemppi.com/decla/amc>.



FCC Compliance Statement

This device complies with Part 15 of the FCC Rules. Operation is subject to the following two conditions:

- (1) this device may not cause harmful interference, and
- (2) this device must accept any interference received, including interference that may cause undesired operation.

NOTE! Changes or modifications made to this equipment not expressly approved by Kemppi Oy may void the FCC authorization to operate this equipment.

Radiofrequency radiation exposure Information

This equipment complies with FCC radiation exposure limits set forth for an uncontrolled environment. This equipment should be installed and operated with minimum distance of 20 cm between the radiator and your body.

This transmitter must not be co-located or operating in conjunction with any other antenna or transmitter.

NOTE! *This equipment has been tested and found to comply with the limits for a Class B digital device, pursuant to Part 15 of the FCC Rules. These limits are designed to provide reasonable protection against harmful interference in a residential installation. This equipment generates, uses and can radiate radio frequency energy and, if not installed and used in accordance with the instructions, may cause harmful interference to radio communications. However, there is no guarantee that interference will not occur in a particular installation.*

If this equipment does cause harmful interference to radio or television reception, which can be determined by turning the equipment off and on, the user is encouraged to try to correct the interference by one or more of the following measures:

- Reorient or relocate the receiving antenna.*
- Increase the separation between the equipment and receiver.*
- Connect the equipment into an outlet on a circuit different from that to which the receiver is connected.*
- Consult the dealer or an experienced radio/TV technician for help.*

Kemppi Oy
www.kemppi.com



1903610
1507