

ArcSensor

The ArcSensor device allows any welding machines equipped with a Euro connector to be monitored with Kemppi's ArcQuality system. For more information about ArcQuality, visit www.kemppi.com/arcquality.

1. Choose the wire guide tube and install it using the 3 adaptor bushes.
2. Connect the ArcSensor to the Euro connector on your wire feeder.
3. Connect the welding gun to the Euro connector on the ArcSensor.
4. Connect the Kemppi ArcQuality Smart Reader to the MIL connector on the ArcSensor.
5. Connect voltage sensing cable and power cord to the ArcSensor connectors.
6. Connect the power transformer to a 230 V wall socket.
7. Connect the branch connector between the earth return lead connector and the power source. Then connect the other end to the power transformer.

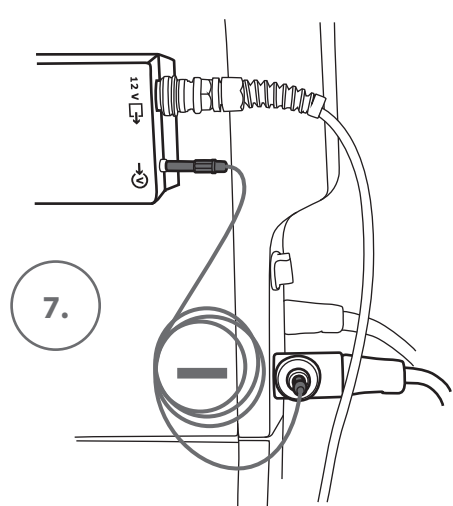
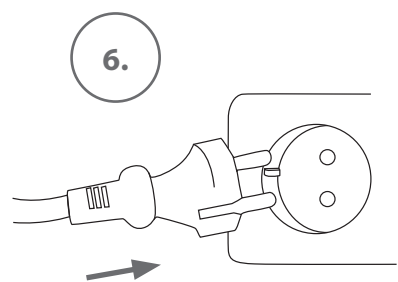
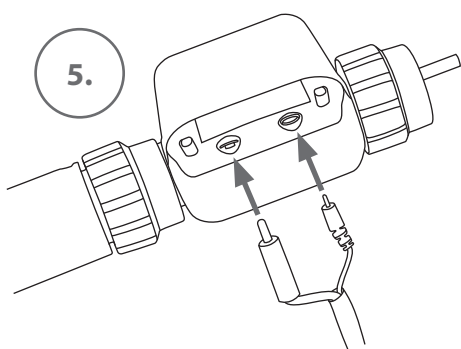
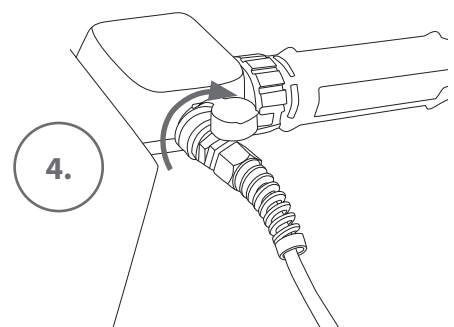
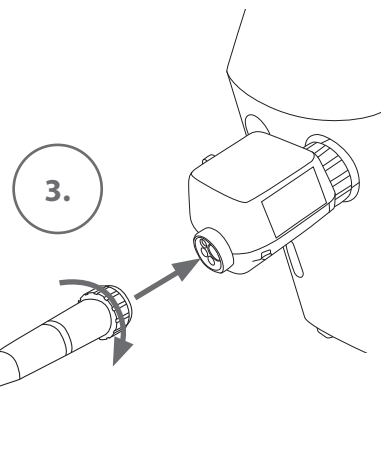
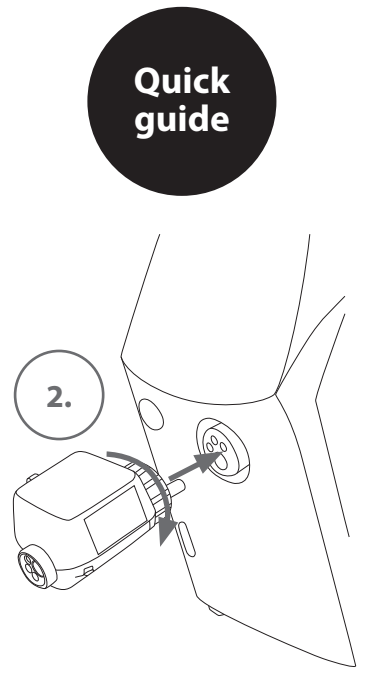
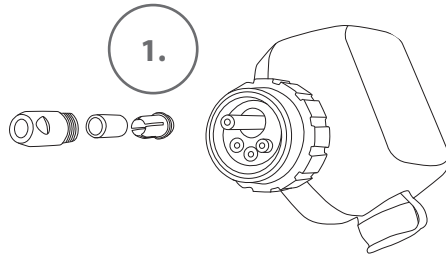

**Quick
guide**

Wire path maintenance

NOTE! You must know the correct tension torques before you start repairing the connections.

NOTE! Only an authorised electrician may repair the machine.

To service or change the wire guide, remove the 3 adaptor bushes.

Three wire guide sizes are available in packages of 5 pcs.

SP007205 wire guide set	
1 pc	wire guide (0.8 – 1.0)
1 pc	wire guide (1.0 – 1.4)
1 pc	wire guide (1.2 – 1.6)
1 pc	adaptor bush
1 pc	adaptor bush
1 pc	adaptor bush

Wire guides					
wire ø mm	guide markings	length	colour	pcs	code
0.8 – 1.0	KEMPPPI 5.9/1.5	99	orange	5	SP007111
1.0 – 1.4	KEMPPPI 5.9/2.0	99	orange	5	SP007112
1.4 – 1.6	KEMPPPI 5.9/2.5	99	orange	5	SP007113

Clean every three months:

Clean the inner parts of the machine from dust and dirt e.g. with a soft brush and avacuum cleaner.

Do not use compressed air because there is the danger that the dirt is packed even more tightly in the gaps of the cooling profiles.

Do not use a pressure washer.

Wire liner must be changed and wire conductor cleaned also to ensure wire speed measurement.

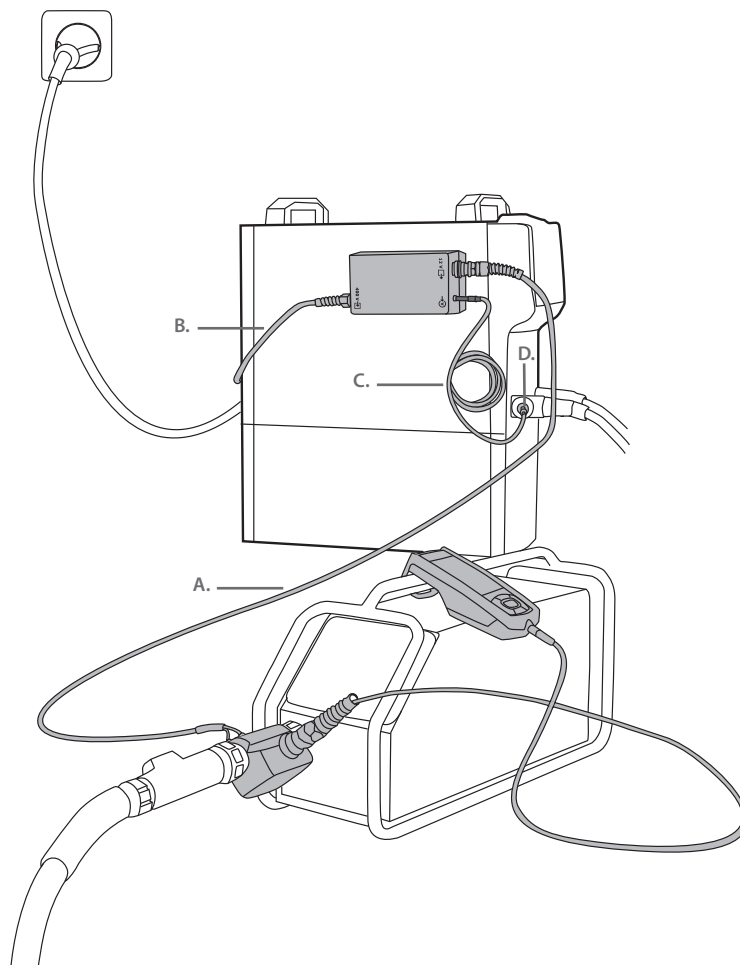

A.	Interconnection cable 12 V	
	5 m	6260700
	25 m	6260701
	50 m	6260702
B.	Input cable	
	1.5 m (4x1.5)	W007928
C.	Measuring cable	
	1.5 m	W007898
D.	DIX angle connector	W003482